

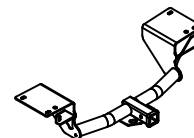

## Class III Receiver Hitch Part No. 69615C



Fits: **CHEVROLET TRAVERSE**



GROSS LOAD CAPACITY WHEN USED AS A WEIGHT CARRYING HITCH: 5,000 LBS. TRAILER WEIGHT & 750 LBS. TONGUE WEIGHT.  
GROSS LOAD CAPACITY WHEN USED AS A WEIGHT DISTRIBUTION HITCH: 7,500 LBS. TRAILER WEIGHT & 750 LBS. TONGUE WEIGHT



**WARNING: \*\*\* DO NOT EXCEED VEHICLE MANUFACTURER'S RECOMMENDED TOWING CAPACITY. \*\*\***

Parts List			
ITEM	QTY	PART NUMBER	DESCRIPTION
1	2	10-10304	BOLT,CAR,1/2-13 UNC,2-1/4,GRD8,YZ
2	2	20-00062	NUT,SER-FLANGE,1/2-13 UNC,GRD8,YZ
3	2	10-10067	HHCS,1/2-13 UNC,2-1/4,GRD8
4	2	30-00149	WASHER,S-CON,1/2,YZ
5	2	CM-SP50	.250 x 1.00 x 1.50" ROUND HOLE SPACER
6	4	10-10490	HHCS,M10x1.5,50,CL10.9,YZ
7	2	1_2 FISHWIRE	1/2" FISHWIRE
8	2	13380-NPWA	NUT PLATE WELDMENT ASSEMBLY

TOOLS REQUIRED	
RATCHET	
TORQUE WRENCH	
+6" SOCKET EXTENSION	
STRAIGHT SCREW DRIVER	
DIE GRINDER	
15MM AND 3/4" SOCKETS	
SAFETY GLASSES	

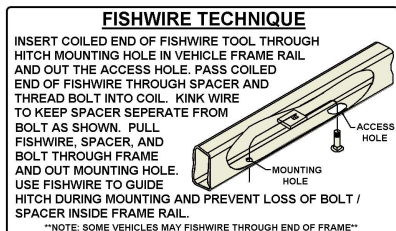

HITCH WEIGHT: 46 LBS.

#### INSTALL TIME

PROFESSIONAL: 35 MINUTES

NOVICE (DIY): 70 MINUTES

#### INSTALL NOTES:

- LOWER EXHAUST
- ENLARGE (2) HOLES
- NO DRILLING REQUIRED
- FISHWIRING REQUIRED

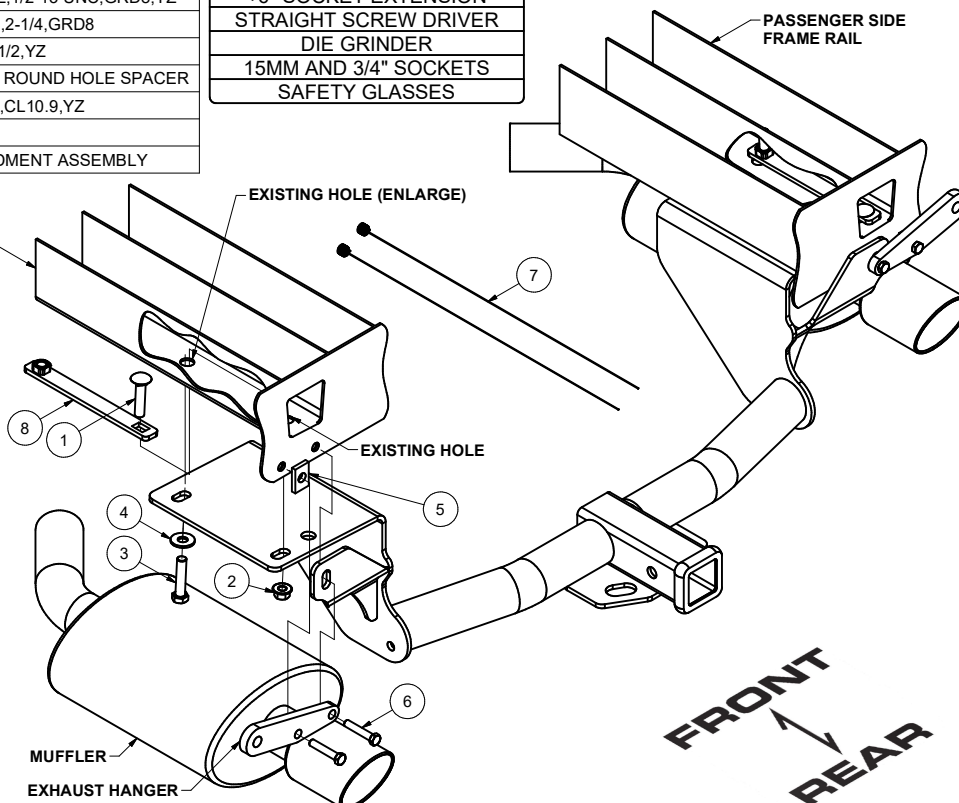

## INSTALLATION STEPS

1. Lower exhaust by removing (4) bolts from each rear exhaust hanger brackets (2 per side) using a 15mm socket, return bolts to owner.

**Note:** Either remove the exhaust heat shields and return to vehicle owner or remove the rearward most heat shield fastener on the frame, return to owner, and compress the heat shield with the hitch.

2. Using a die grinder, enlarge the forward mounting hole to accept the supplied nut plates. Fishwire the supplied 1/2" carriage bolt into the rectangular hole in the nut plate and into the rearwardmost mounting hole. Slide the nut plates into the enlarged hole (one per side) with the nut towards the front of the vehicle.
3. Carefully raise hitch into position with the rear tabs on the rearward side of the frame flange so as not to push the carriage bolts into the frame. Install the (2) 1/2" hex bolts and conical tooth washers into the nut plate. Install the remaining 1/2" hex flange nuts. Torque all 1/2 fasteners to 110 lb-ft
4. Using the supplied M10 bolts, raise the exhaust back into position and install the bolts with the spacer on the outboard mounting location between the frame and the exhaust hanger as shown above. Torque all M10 fasteners to 45 lb-ft.

**PERIODICALLY CHECK THIS RECEIVER HITCH TO ENSURE THAT ALL FASTENERS ARE TIGHT AND THAT ALL STRUCTURAL COMPONENTS ARE SOUND.**

Keystone Automotive Operations Inc., warrants this product to be free of defects in material and/or workmanship at the time of retail purchase by the original purchaser. If the product is found to be defective, Keystone Automotive Operations Inc., may repair or replace the product, at their option, when the product is returned, prepaid, with proof of purchase. Alteration to, misuse of, or improper installation of this product voids the warranty. Keystone Automotive Operations Inc.'s liability is limited to repair or replacement of products found to be defective, and specifically excludes liability for incidental or consequential loss or damage. This product complies with safety specifications and requirements for connecting devices and towing systems of the state of New York, V.E.S.C. Regulation V-5 and SAE J684. For Technical & Warranty Support : 1-877-544-4449 Fax- 1-855-242-8922 [www.huskytow.com](http://www.huskytow.com)

07102020